

**ITEM 21. ROAD WORKS – TEMPORARY ROAD CLOSURES – GROSE
STREET GLEBE**

TRIM RECORD NO: 2016/573706

RECOMMENDATION

It is recommended that the Committee endorse the temporary road closure of Grose Street, between Bay and Francis Streets, Glebe for the following three stages:

- Stage 1 – 8pm to 6am, Sunday 19 to Thursday 23 February 2017;
- Stage 2 – from 8pm on Friday 24 February through to 6am on Monday 27 February 2017; and
- Stage 3 – from 8pm on Monday 27 February through to 6am on Tuesday 28 February 2017.

Subject to the following conditions:

- (A) The Applicant must comply with the temporary road closure conditions as mentioned in Schedule C of this Agenda.
- (B) The Applicant must comply with any other conditions imposed by City's Construction Regulation Unit.
- (C) The Applicant has indicated from 26 February to 2 March 2017 between 8pm and 6am; from 8pm on 3 March through to 6am on 6 March 2017; and from 8pm on 7 March to 6am on 8 March 2017 as an additional period for the road works as a contingency for inclement weather.
- (D) The Applicant must contact Leichhardt Police to obtain a separate police permit and to discuss deployment of user pay police for the road closures.
- (E) The Applicant is to obtain a Road Occupancy Licence from the Transport Management Centre prior to commencement of works.
- (F) The Applicant must provide a telephone number of the supervisor responsible for the proposed closures and include contact details in the notification letters to be distributed to affected stakeholders.

VOTING MEMBERS FOR THIS ITEM

<i>Voting Members</i>	<i>Support</i>	<i>Object</i>
City of Sydney		
Roads and Maritime Services		
NSW Police – Leichhardt LAC		
Representative for the Member for Balmain		

DECISION

BACKGROUND

Mainbrace Constructions has applied for the temporary road closure of Grose Street, between Bay and Francis Streets, Glebe in following three stages:

- Stage 1 – 8pm to 6am, Sunday 19 to Thursday 23 February 2017;
- Stage 2 – from 8pm on Friday 24 February through to 6am on Monday 27 February 2017; and
- Stage 3 – from 8pm on Monday 27 February through to 6am on Tuesday 28 February 2017.

COMMENTS

The proposed temporary road closures are required to enable construction of a new raised pedestrian crossing across Grose Street, just west of Bay Street.

The Applicant has advised that these works will be done in the following three stages:

- Stage 1 will involve removal of existing asphalt, preparation of new levels and drainage works – these works will be completed at night between 8pm and 6am;
- Stage 2 will include pouring of the concrete slab followed by 48 hours of curing time before the street is opened to vehicular traffic; and
- Stage 3 will involve line marking and some ancillary works to complete the project.

The Applicant has provided a site-specific Traffic Control Plan that includes details of barricades, signs, flagmen and other traffic devices to implement the proposed road closures.

There are currently no other approved temporary road closures proposed to take place on the same day in close proximity of this closure.

The temporary road closures will not affect any other properties, as local access will be provided at all times and alternative access routes are available nearby.

CONSULTATION

The Applicant will be required to notify affected stakeholders as stipulated in Schedule C.

FINANCIAL

All costs associated with the proposed closures will be borne by the Applicant.

ATTACHMENTS

Road Works – Temporary Road Closures – Grose Street Glebe

Shan Shanmugalingam, Technical Support Officer

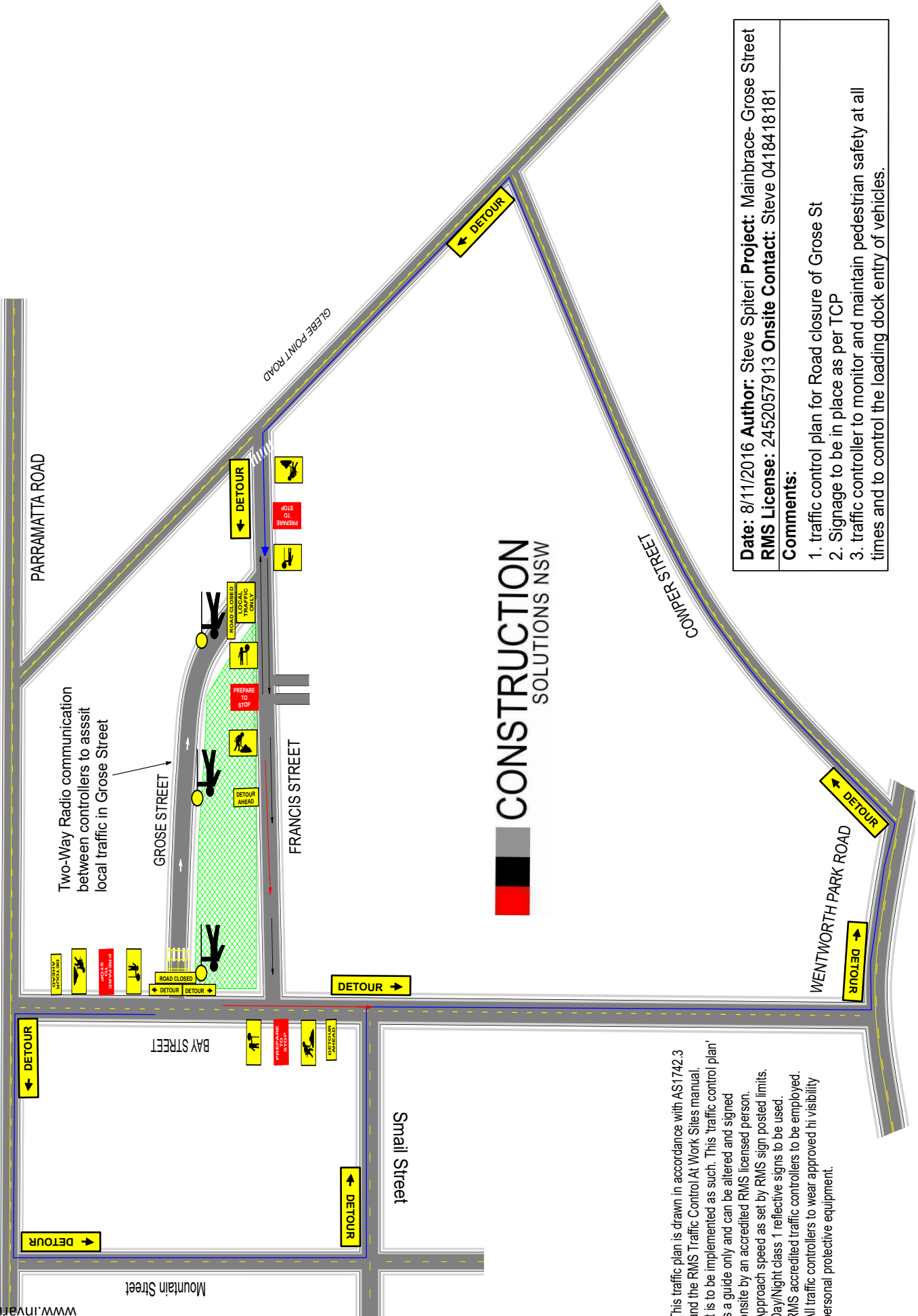

This traffic plan is drawn in accordance with AS1742.3 and the RMS Traffic Control At Work Sites manual. It is to be implemented as such. This 'traffic control plan' is a guide only and can be altered and signed onsite by an accredited RMS licensed person. Approach speed as set by RMS sign posted limits. Day/Night class 1 reflective signs to be used. RMS accredited traffic controllers to be employed. All traffic controllers to wear approved hi visibility personal protective equipment.

Date: 8/11/2016 **Author:** Steve Spiteri **Project:** Mainbrace- Grose Street
RMS License: 2452057913 **Onsite Contact:** Steve 0418418181

- Comments:**
1. traffic control plan for Road closure of Grose St
 2. Signage to be in place as per TCP
 3. traffic controller to monitor and maintain pedestrian safety at all times and to control the loading dock entry of vehicles.

